

MOD : IE140/R9

Production code : 19102493

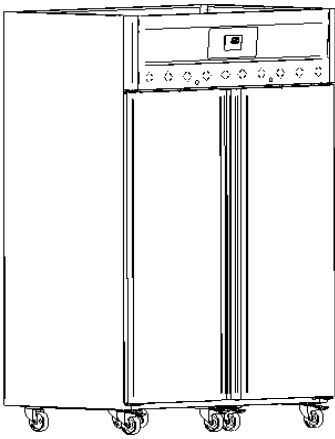

Specific model

IE140/R9 C 230V 1N 50Hz

19102493

24/04/2023

DIMENSIONS

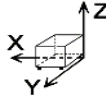

X Width	1358 mm	X Gross width	1430 mm
Y Depth	856 mm	Y Gross depth	880 mm
Z Height	2145 mm	Z Gross height	2185 mm
Net Weight	227,0 kg	Gross Weight	240,0 kg
Net volume	2,371 m3	Gross volume	2,750 m3

ELECTRICITY TECHNICAL SPECIFICATIONS

Electric power	0,749 kW
Amperage (A)	4,3 A
Voltage	230V - 1N
Electric frequency	50Hz

GAS TECHNICAL SPECIFICATIONS

Gas type	R-290
----------	-------

COLD TECHNICAL SPECIFICATIONS

Climate class	4
Cooling gas load	138,000 g
Refrigeration power	0,907 kW
Clasif. Energy efficiency	E
Energy Efficiency Index	83,89 %
Annual elec. consumption	5183 kWh
Model Type	Vertical cabinet
Power consumption 24h	14,2 kWh
Gross internal volume	1332 L
Frozen net.vol	955 L

CONNECTIONS TECHNICAL SPECIFICATIONS

Single-phase 230V wiring	2X1,5+T-2A
--------------------------	------------

OTHERS

Noise level	58,00 dB
Condensation system	Vent.

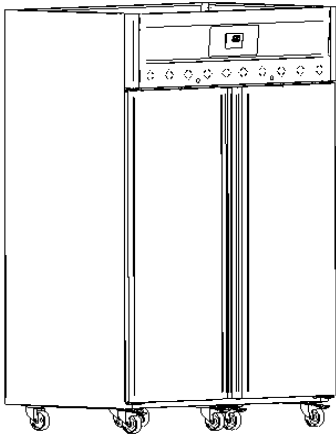

Specific model

IE140/R9 C 230V 1N 50Hz

19102493

24/04/2023

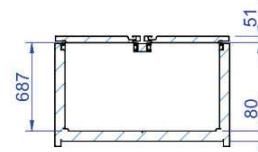
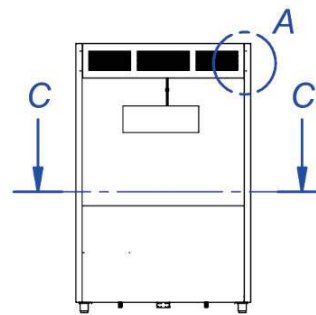
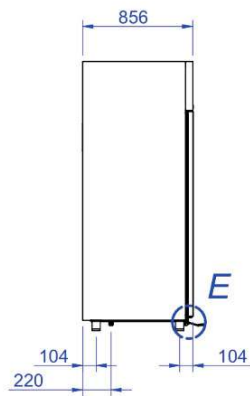
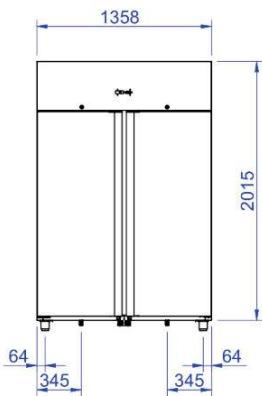

SECTION C-C

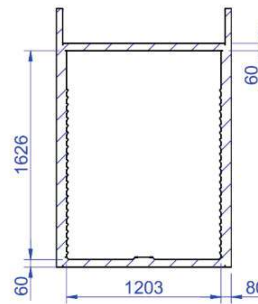
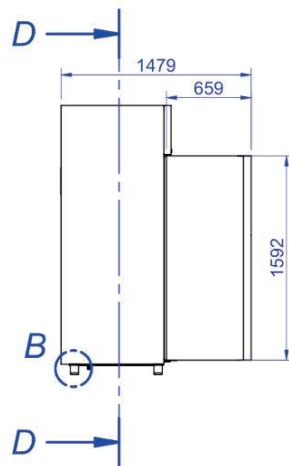

SECTION D-D

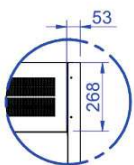
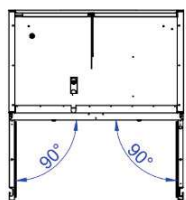

A
ELECT.

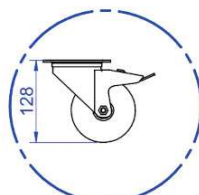

"R" OPTION

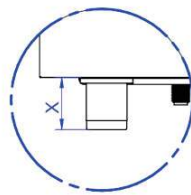

80 < X < 115

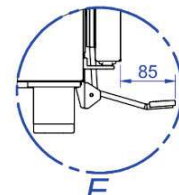

E
"PD" OPTION